

# Eclipse setup

An *epf* (Eclipse Preferences File) has been created and is available both as an attachment to this page [Magnolia.epf](#) and on our fileserver at */Product Development/Eclipse/Magnolia.epf* (access restricted to Magnolia International devs only). This file needs to be imported into your Eclipse IDE and will automatically set the formatting options as specified in our [code style page](#).

Go to **File -> Import -> General -> Preferences**

Make sure you **Import all** not only the Java Code Style Preferences.

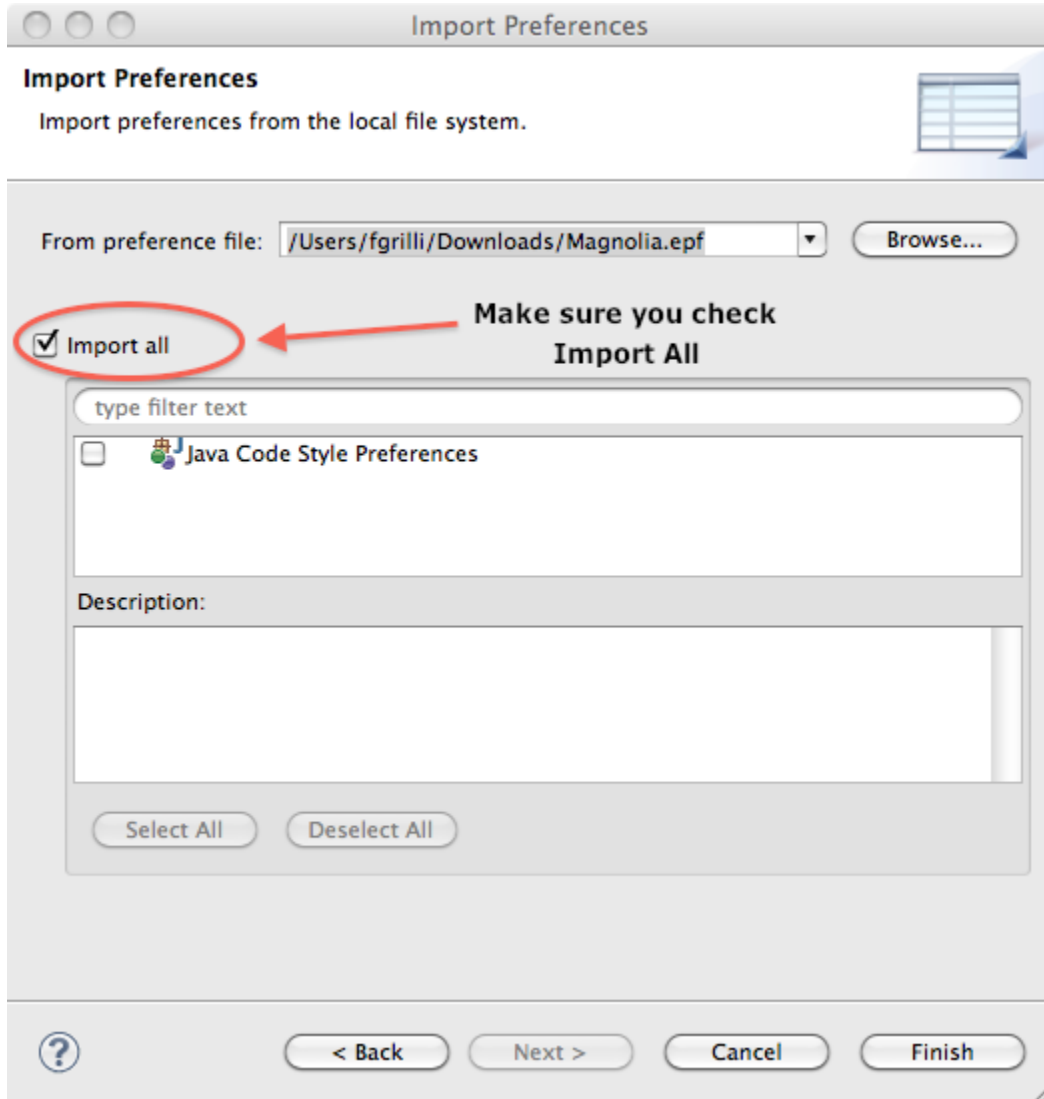

The settings provided will only overwrite the following and should not interfere with other default or custom settings

- Java -> Code Style -> Formatter ("Magnolia" profile based on Eclipse-provided Java code conventions profile)
- XML -> XML Files -> Editor
- Java -> Editor -> Save Actions
- Java -> Code Style -> Organize imports

Alternatively, if you have access to our fileserver a zipped Eclipse Indigo bundle with the *Magnolia.epf* already set can be downloaded from */Product Development/Eclipse/* folder.

By default, this profile will automatically apply code formatting and imports re-ordering upon saving. You can also apply formatting and imports ordering manually by selecting a file or group of files, then **right-click -> Source -> Clean up...**

**Make sure the active profile is Magnolia and NOT Eclipse [built-in]**

**Note: If you suspect that the correct settings are not being applied:**

You may have to switch the active profile manually away from "Magnolia", click Apply, close and re-open the preferences, then switch the active profile back to "Magnolia" and apply again.